

LED PANEL LAMPS



Flush Diamond lens and 6" stripped wire leads shown here.

Long Life, Solid State, light emitting diodes make this series of snap-in lamps a very dependable component. Available in popular voltages as well as the standard LED voltage (2 Volt series); use Ohm's law to calculate a series resistor if other voltages are needed. All LED'S on this page operate at 20 mA DC typical.

Specifications:
 Body Material: Nylon
 Lens material: Polycarbonate
 Bezel material: Brass (plated)
 Wire Gauge: 18 ga.
 Wire Strip: 1/2"
 Terminals: .187 QC
 Panel Thickness: 0.030" min
 Certifications: 2V - cUL, TUV
 12 - 14V - UL, TUV
 24-28V - TUV, CE

LED LAMP ASSEMBLIES are available in two sizes: for .312" diameter panel holes and for .500" diameter panel holes. Lens styles are either flush with the front of the lamp or about 0.30" above the front in the "high rings style".

LED LAMPS for .312" diameter mounting holes

Part no.	Voltage	Description	Terminals
11-2500	2-volt	RED flush diamond lens	6" stripped leads
11-2501	2-volt	GREEN flush diamond lens	6" stripped leads
11-2502	2-volt	AMBER flush diamond lens	6" stripped leads
11-2510	2-volt	RED-high rings lens	6" stripped leads
11-2511	2-volt	GREEN-high rings lens	6" stripped leads
11-2512	2-volt	AMBER high rings lens	6" stripped leads
11-2520	12-14 Volt	RED-flush diamond lens	6" stripped leads
11-2521	12-14 Volt	GREEN-flush diamond lens	6" stripped leads
11-2522	12-14 Volt	AMBER-flush diamond lens	6" stripped leads
11-2530	12-14 Volt	RED-high rings lens	6" stripped leads
11-2531	12-14 Volt	GREEN-high rings lens	6" stripped leads
11-2532	12-14 Volt	AMBER-high rings lens	6" stripped leads
11-2540	12-14 Volt	RED-flush diamond lens	.187" terminal lug
11-2541	12-14 Volt	GREEN-flush diamond lens	.187" terminal lug
11-2542	12-14 Volt	AMBER-flush diamond lens	.187" terminal lug
11-2550	24-28 Volt	RED-flush diamond lens	6" stripped leads *
11-2551	24-28 Volt	GREEN-flush diamond lens	6" stripped leads *
11-2552	24-28 Volt	AMBER-flush diamond lens	6" stripped leads *

NOTE: * = for 24-28 volt, lamp body is .94" (vs 1.43")

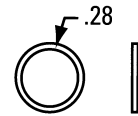

Flush Diamond Lens

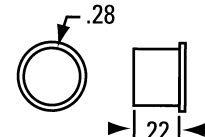

High Ring Lens

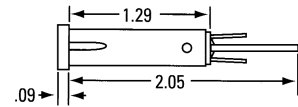

.187 Terminal Lugs

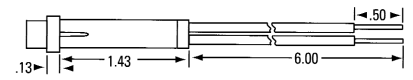

6" Stripped Leads



LED LAMPS for .50" diameter mounting holes

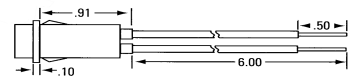

6" Stripped Leads

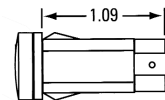

.187 Terminal Lugs

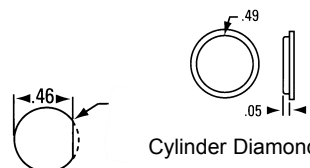

Cylinder Diamond Lens

Part no.	Voltage	Description	Terminals
11-2560	2-volt	RED cylinder diamond lens	6" stripped leads
11-2561	2-volt	GREEN cylinder diamond lens	6" stripped leads
11-2562	2-volt	AMBER cylinder diamond lens	6" stripped leads
11-2570	12-14 volt	RED-cylinder diamond lens	6" stripped leads
11-2571	12-14 volt	GREEN-cylinder diamond lens	6" stripped leads
11-2572	12-14 volt	AMBER cylinder diamond lens	6" stripped leads
11-2580	12-14 Volt	RED-cylinder diamond lens	.187" tabs
11-2581	12-14 Volt	GREEN-cylinder diamond lens	.187" tabs
11-2582	12-14 Volt	AMBER-cylinder diamond lens	.187" tabs
11-2590	24-28 Volt	RED-cylinder diamond lens	6" stripped leads
11-2591	24-28 Volt	GREEN -cylinder diamond lens	6" stripped leads
11-2592	24-28 Volt	AMBER-cylinder diamond lens	6" stripped leads

For 11-2580, 11-2581 & 11-2582 only